

S 34° 59'30" W 67.00'

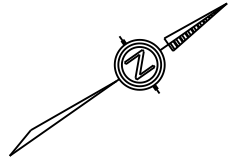

PART 4
LOT 333
REG. PLAN No. 30R-10820
IN THE TOWN OF NIAGARA ON THE LAKE
REGIONAL MUNICIPALITY OF NIAGARA
SIMCOE STREET

LOT AREA = 13 985 SF
BUILDING GROSS AREA = 2 665 SF
% LOT COVERAGE = 19.1 %

N 55° 8'20" W 63.00'

105' 1"

S 55° 8'20" E 208.882'

N 55° 8'20" W 145.58'

78' 10"

77' 6"

25' 0"

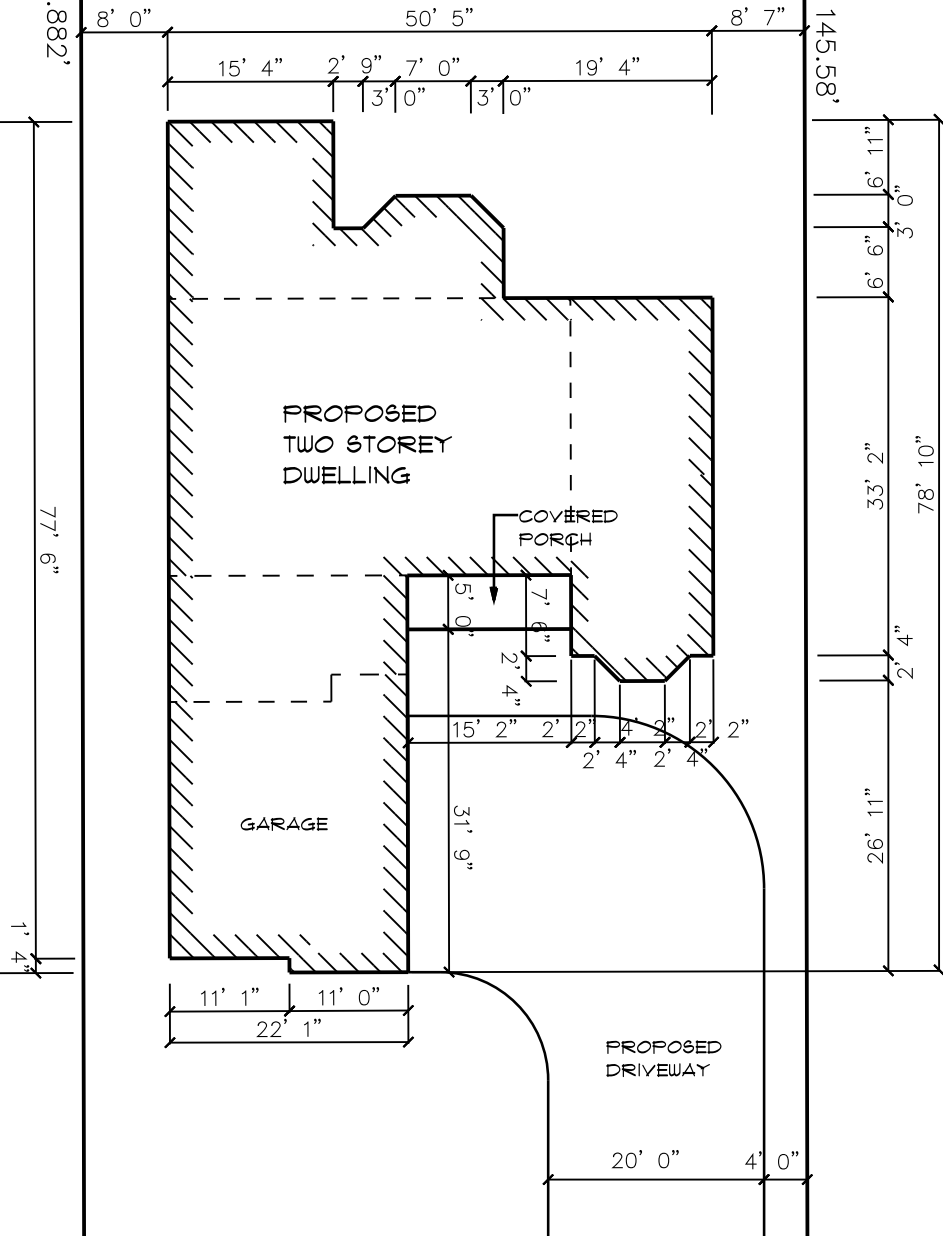

N 34° 44'0" E 67.00'

SIMCOE STREET